

Schottadapter Typ 15-220../						
Metrisches Schottgewinde mit 24°-Innenkonus, zölliges Einschraubgewinde (zylindrisch).						
Art. Nr.	Bezeichnung	Standard	R1	G1	G2	
Art. N°	Description					
122.750	15-220/L06 G1/8"	•	L06	M12x1,5	G1/8"	
122.751	15-220/L06 G1/4"		L06	M12x1,5	G1/4"	
122.800	15-220/L08 G1/4"	•	L08	M14x1,5	G1/4"	
122.802	15-220/L08 G3/8"		L08	M14x1,5	G3/8"	
122.804	15-220/L08 G1/2"		L08	M14x1,5	G1/2"	
122.801	15-220/L10 G1/4"	•	L10	M16x1,5	G1/4"	
122.821	15-220/L10 G3/8"		L10	M16x1,5	G3/8"	
122.805	15-220/L10 G1/2"		L10	M16x1,5	G1/2"	
122.752	15-220/L12 G1/4"		L12	M18x1,5	G1/4"	
122.803	15-220/L12 G3/8"	•	L12	M18x1,5	G3/8"	
122.806	15-220/L12 G1/2"		L12	M18x1,5	G1/2"	
122.753	15-220/L15 G3/8"		L15	M22x1,5	G3/8"	
122.808	15-220/L15 G1/2"	•	L15	M22x1,5	G1/2"	
122.811	15-220/L15 G3/4"		L15	M22x1,5	G3/4"	
122.810	15-220/L18 G1/2"	•	L18	M26x1,5	G1/2"	
122.813	15-220/L18 G3/4"		L18	M26x1,5	G3/4"	
122.817	15-220/L18 G1"		L18	M26x1,5	G1"	
122.755	15-220/L22 G1/2"		L22	M30x2	G1/2"	
122.815	15-220/L22 G3/4"	•	L22	M30x2	G3/4"	
122.757	15-220/L28 G3/4"		L28	M36x2	G3/4"	
122.825	15-220/L28 G1"	•	L28	M36x2	G1"	
122.758	15-220/L28 G1.1/4"		L28	M36x2	G1.1/4"	
122.828	15-220/L35 G1.1/4"	•	L35	M45x2	G1.1/4"	
122.760	15-220/L35 G1.1/2"		L35	M45x2	G1.1/2"	
122.761	15-220/L42 G1.1/2"	•	L42	M52x2	G1.1/2"	
122.762	15-220/S06 G1/4"	•	S06	M14x1,5	G1/4"	
122.763	15-220/S08 G1/4"	•	S08	M16x1,5	G1/4"	
122.766	15-220/S10 G3/8"	•	S10	M18x1,5	G3/8"	
122.767	15-220/S10 G1/2"		S10	M18x1,5	G1/2"	
122.769	15-220/S12 G3/8"	•	S12	M20x1,5	G3/8"	
122.807	15-220/S12 G1/2"		S12	M20x1,5	G1/2"	
122.819	15-220/S14 G1/2"	•	S14	M22x1,5	G1/2"	
122.809	15-220/S16 G1/2"	•	S16	M24x1,5	G1/2"	
122.812	15-220/S16 G3/4"		S16	M24x1,5	G3/4"	
122.772	15-220/S20 G1/2"		S20	M30x2	G1/2"	
122.814	15-220/S20 G3/4"	•	S20	M30x2	G3/4"	
122.777	15-220/S20 G1"		S20	M30x2	G1"	
122.816	15-220/S25 G3/4"		S25	M36x2	G3/4"	
122.818	15-220/S25 G1"	•	S25	M36x2	G1"	
122.822	15-220/S25 G1.1/4"		S25	M36x2	G1.1/4"	
122.820	15-220/S30 G1"		S30	M42x2	G1"	
122.827	15-220/S30 G1.1/4"	•	S30	M42x2	G1.1/4"	
122.774	15-220/S38 G1.1/4"		S38	M52x2	G1.1/4"	
122.775	15-220/S38 G1.1/2"	•	S38	M52x2	G1.1/2"	

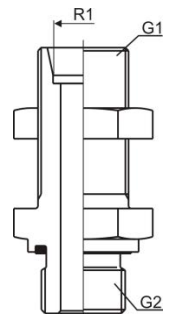

Standard Standardgröße / Standard size
R1 Rohrgröße / Pipe size
G1 Gewinde / Thread
G2 Gewinde / Thread